

Project Name: \_\_\_\_\_

Date: \_\_\_\_\_ Note: \_\_\_\_\_

## LED Waterproof Integrated Linear Light

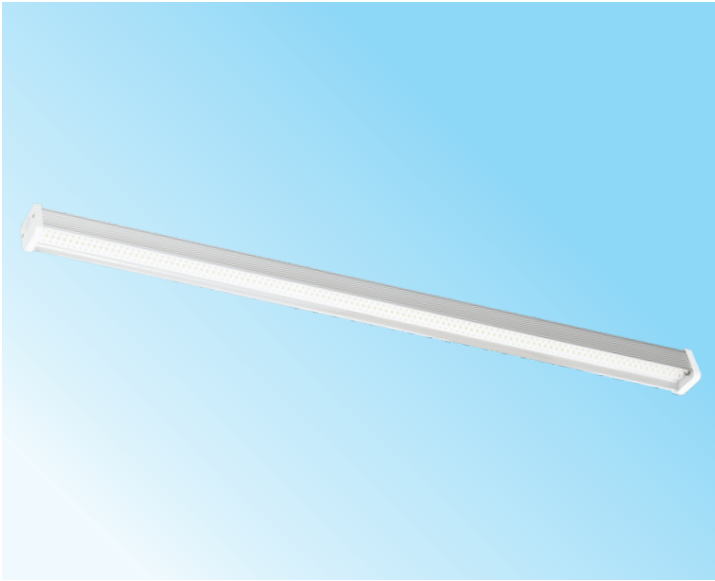

**Application:** Awning, Parking garages; docks; subway station; canopy; walk-in refrigerators and etc.

### Certifications



### FEATURE

- Waterproof IP65: ideal economical choice for wet and damp location (indoors or outdoors)
- Body: Durable 6063 extruded aluminum for efficient heat dissipation
- Easy Installation: back mounting clip for easy and quick installation

### SPECIFICATIONS

Model No.	HY-WPINT-4FT-36W-XXK	HY-WPINT-8FT-72W-XXK
Wattage	36W	72W
Size	4FT	8FT
Lumens	4680 LM	9360 LM
Rated Input Voltage(V)	120-277V	
Cover	Clear/Frosted	
CCT	6500K	
Body	Aluminum	
Beam Angle (°)	110°	
Dimming	Non Dimmable	
Lumen Efficiency	130 Lm/W	
Color Rendering Index	Ra>80	
Power Factor	0.95	
Working Temperature	-4 ° F ~+105 ° F / -15°C ~40°C	
Storage Temperature	-4 ° F ~+105° F / -15 ° C ~ +40 ° C	
Environment Location	IP 65	
Lifespan	Lumen Maintenance over 70% @ 50,000+ Hours	
Warranty	5 Years Limited	
Certificate	ETL	
Package Info	51.2"X9.4"X9.3"	96.9"X9.4"X9.3"
PC/ Master Pack	20	20
Weight	29 lbs	53 lbs

### ACCESSORIES



Mounting clips



Screws 2

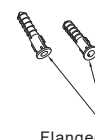

Flanged Wall Anchor

Optional Hanging Kit (Not Come with Light/Purchase Separately)



Screws 1



Suspension Cable Base

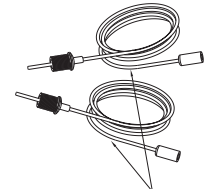

Suspension Cable

## ORDERING CODE DEFINITION

**EXAMPLE: HY-WPINT-4FT-36W-XXK**

Company Code	Product	Size	Power:	CCT
HY	WPINT : LED Waterproof Integrated Light	4FT	36W	6500K
		8FT	72W	

## PRODUCT DIMENSION

8ft Front View

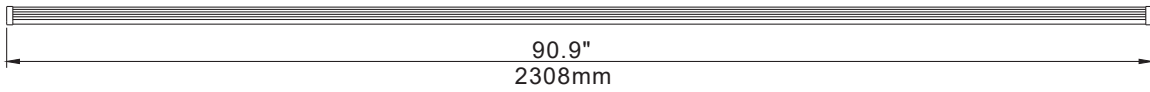

Side View

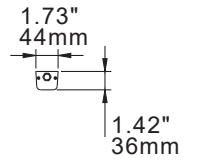

4ft Front View

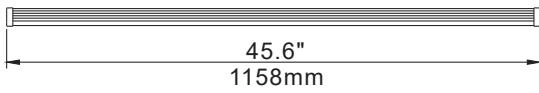

Side View

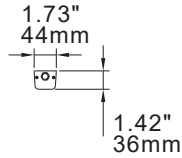

## FEATURE

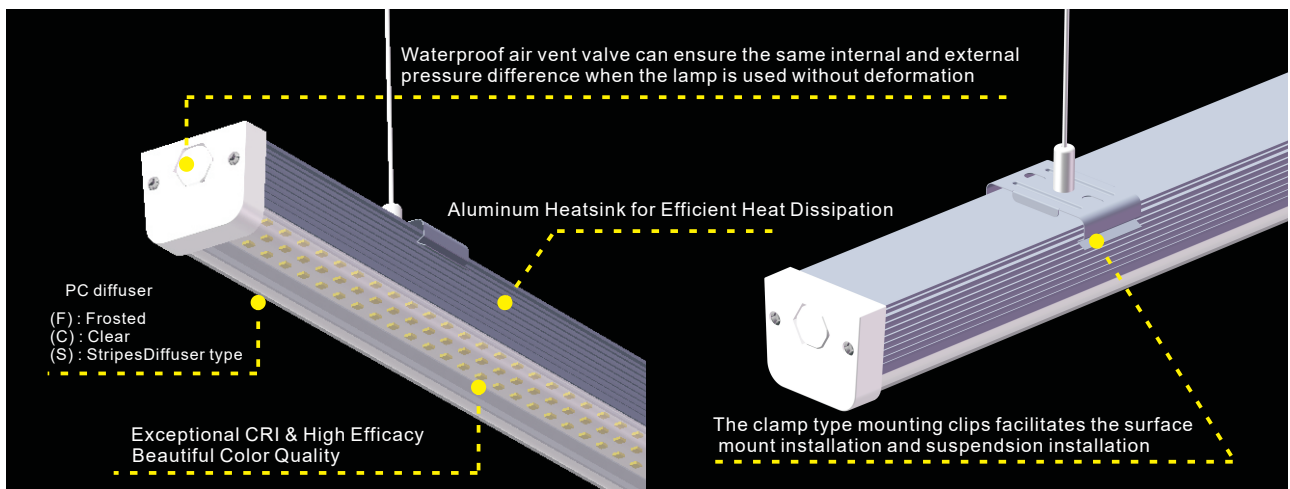

## PHOTOMETRICS

LUMINOUS INTENSITY DISTRIBUTION DIAGRAM

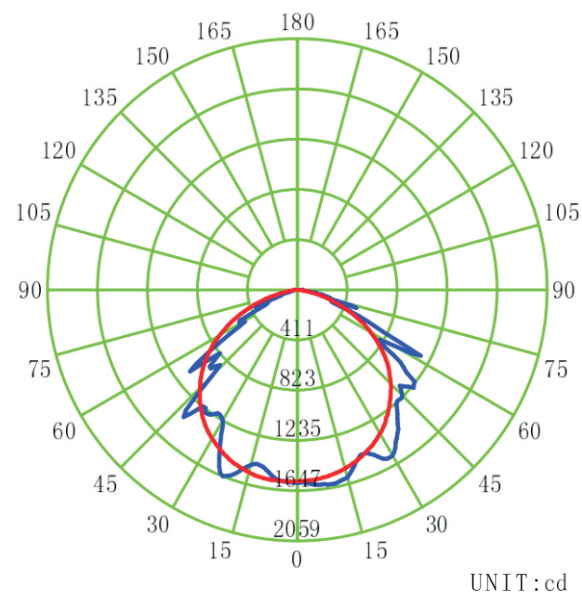

VERTICAL EQUILUMINOUS CURVE

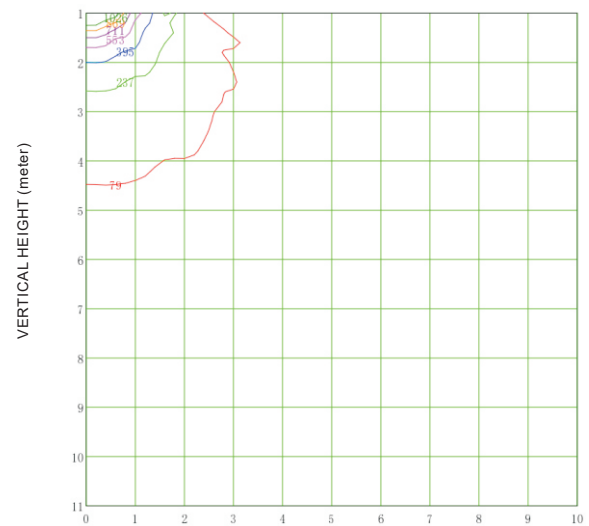

HORIZONTAL DISTANCE (meter)

MINIMUM ALTITUDE 1.0 M  
MAXIMUM ALTITUDE 11.0 M  
MAXIMUM ILLUMINATION 1579.2 lx

— ( 5% ) : 79.0 lx	— ( 15% ) : 236.9 lx
— ( 25% ) : 394.8 lx	— ( 35% ) : 552.7 lx
— ( 45% ) : 710.6 lx	— ( 55% ) : 868.6 lx
— ( 65% ) : 1026.5 lx	

# INSTALLATION GUIDE

## A Surface mount installation

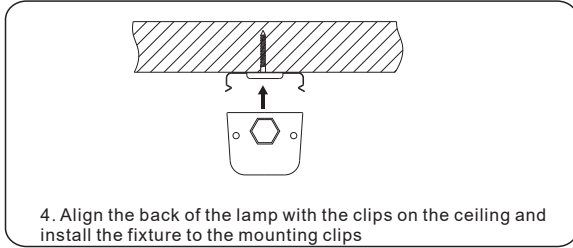
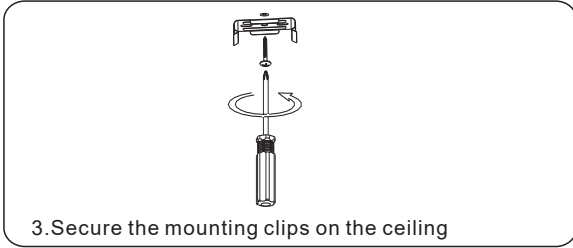
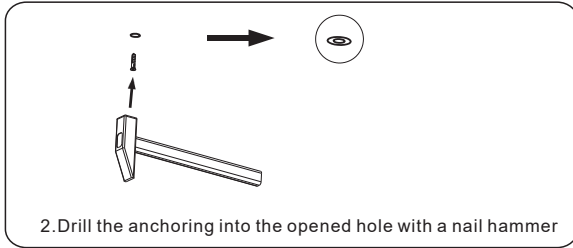
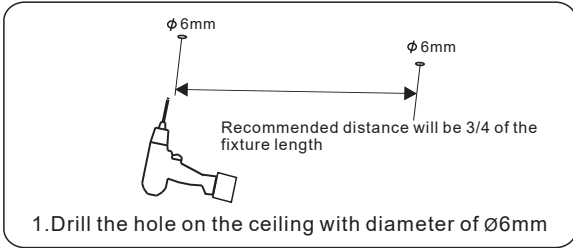

## B Suspension installation

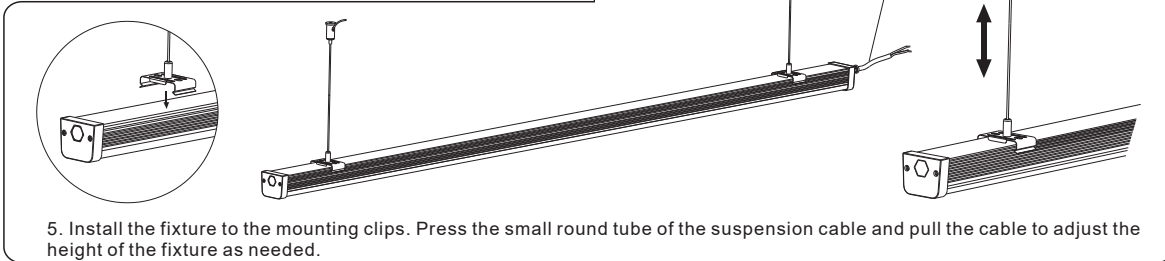
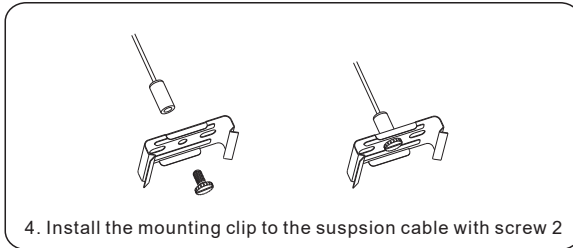
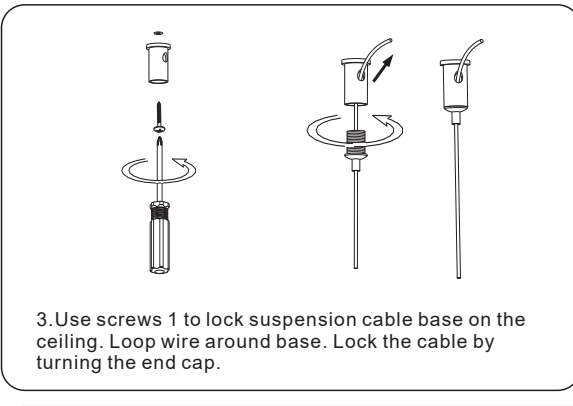
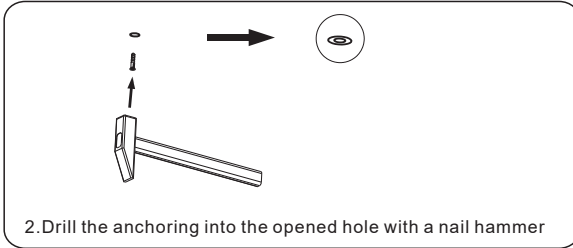
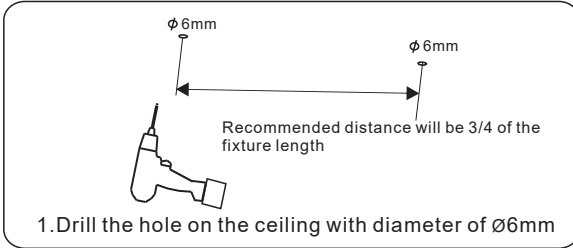

## C Wiring Guide

